

Camper Trailers

2015



ENJOY NEW FOUND
FREEDOM IN AUSTRALIA'S
MOST POPULAR RV

Owning a Jayco Camper Trailer is practically an Australian tradition for young families. Your ticket to the simple joys of a holiday along the coast, by a river somewhere, or deep in the great outdoors, this ideal first RV will become a much-loved source of cherished lifelong memories.

Because every family is different, there's a choice of seven floor plans. The smallest sleeps five, while the largest accommodates as many as eight. Each is lightweight for easy towing by a wide range of vehicles, compact for convenient storage in your garage, carport or backyard, and each is offered in an Outback version suitable for venturing cross-country.

Like every Jayco, our Camper Trailers are designed for comfort, built to last, and equipped for effortless enjoyment. Setting up on arrival is a breeze. With the help of our patented roof lifter system, a couple of minutes is all it takes.

And don't forget the other advantages of Jayco ownership – no matter which Camper Trailer you choose, you can look forward to:

- **nationwide support** from Australia's **largest dealer and service network**, comprising more than 100 locations around the country;
- **24-hour roadside assist*** for three years, ensuring you're only ever a phone call from the support you need; and a
- **comprehensive 12-month warranty** regarded as the industry benchmark.

Add up all the benefits, on this page and those that follow, and you'll start to see why Jayco Camper Trailers are rated number one for value; and why, just as importantly, they'll hold that value better than any other brand should you ever decide to upgrade.



WHERE
MOMENTS
BECOME
MEMORIES

...

that's where a Jayco
will take you

SMALL TO TOW,
BIG TO LIVE IN



*conditions apply

LAKE ILLAWARRA SOUTH COAST NSW © Tourism Australia / Con Poulos. inset: MURRAYLANDS SA © SATC / Adam Bruzzone

NATIONWIDE SUPPORT

100+ SERVICE
AND DEALER
LOCATIONS



ROADSIDE ASSIST

3 YEARS
24 HOURS
365 DAYS



WARRANTY PROGRAM

12 MONTHS'
COMPREHENSIVE
COVERAGE



BETTER VALUE

MORE
FEATURES
FOR LESS



HIGHER RESALE VALUE

A SMARTER
INVESTMENT
IN THE
LONG RUN



EVERYTHING IS EASIER WHEN YOU HOLIDAY THE JAYCO WAY

Our Camper Trailers don't just make getting there easy – top to bottom, inside and out, every detail of a Jayco is designed to make all aspects of your holidays easier, more comfortable and more enjoyable for every family member.

That's the difference our four decades of local design and manufacturing experience makes. We understand that you want to tow small, but live large, with ample space for relaxing, innerspring mattresses for a restful sleep, quality appliances for cooking, and enough storage to carry your essentials. So that's what we give you – including a large, five-foot wide parents' bed with most floor plans.

We also appreciate you may want to personalise your Jayco. Not just through your preferred choice of fabrics and finishes, but with accessories relevant to your favourite leisure activities. Like a roof rack for the family tinnie, bike racks, or an awning for all-weather outdoor entertaining.



STEP 1



STEP 2

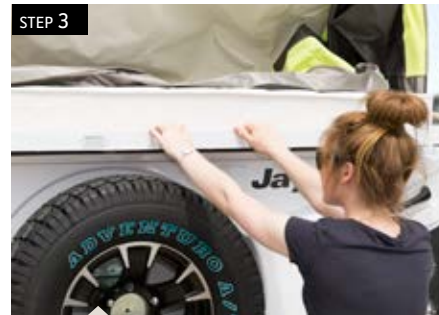

STEP 3



STEP 4

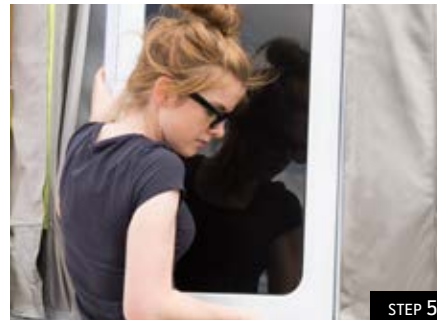

STEP 5



STEP 6

QUICK AND EASY SETUP Once you arrive, it takes no time at all to set up your Camper Trailer, so you can start enjoying your time away sooner.

STEP 1. Unclip the corner roof latches

STEP 2. Use the fully enclosed winder system to raise the roof

STEP 3. With the roof raised, slide both bed ends out

STEP 4. Place the external supports under each end bend

STEP 5. Fold down the upper section of the stowable split door and connect with the lower section

STEP 6. Hinge each end frame up and slide the internal support pole into place



1



2



3



1 Four-burner gas cooktop with electric hotplate and flame out protection (N/A Swift). **2** Rear bed restraints to help young children sleep safely. **3** Innerspring mattress for comfort and support. **4** Dual illumination 12-volt LED ceiling light with bright and mood settings. **5** Kitchen drawers operate at the touch of a finger. **6** Combination fan and 12-volt light for bed time reading. **7** The large stainless steel sink includes a dual-sided chop 'n' serve board.



4



5



6



7

BUILT IN AUSTRALIA SINCE 1975
AND STILL GOING STRONG

Jayco RVs have been helping Australians live their holiday dreams for 40 years. We began in 1975, in the garage of a suburban home; our ambition, to build a better Camper Trailer. Today, Jayco is the most popular brand on the market. We've built, sold and supported more than 170,000 RVs to date, and now operate a 20-hectare manufacturing facility in Melbourne that employs a local workforce of 1,000+ people.

From that first Camper, Jayco has made high-quality products that offer outstanding value for money and lasting peace of mind. It's an advantage we deliver more than ever now through increased manufacturing efficiencies; proprietary technology, such as **JTECH SUSPENSION**, the **JAYCO MAXIFRAME** and **JAYCO ENDURANCE CHASSIS**; and a commitment to using better materials, more precise craftsmanship, and ever-smarter design ideas and construction methods, for example:

- The **patented roof lifter system** minimises winding effort, eliminates slippage, maximises stability, is fully enclosed to prevent damage and comes with a lifetime warranty to the original owner (winch only)
- The tent section is made of high quality, **Australian-made Bradmill canvas**, computer cut for accuracy and double-stitched for longevity
- The **one-piece fiberglass** roof is interlocked in position for added strength, and features protective corner moulds and extruded, powder-coated sidewalls with an in-built annexe track
- Our Eurostyle aluminium framed furniture features **protective curved extrusions** for strength and elegance, positive cupboard catches to secure your valuables in transit, and cabinet fronts that are screwed into place, not stapled
- Cushions are made from **high-resilience Dunlop™** foam, for years of comfort and support, and upholstery is treated with **antimicrobial protection** to inhibit mould, mildew and fungi, as well as dust mite protection to help prevent asthma and allergy-related conditions
- Tyres are **inflated with nitrogen** – not everyday air – reducing fuel usage, tyre wear and the risk of blowouts, while also improving ride and handling.

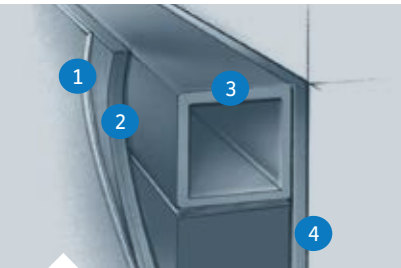

THE JAYCO QUAD-LAYER MAXIFRAME Our Camper Trailers are built with the Jayco Maxiframe. This quad-layer wall construction technology is both stronger and lighter than those of conventional 'timber & tin' aluminium clad RVs.

1. **Hail and dent resistant fiberglass exterior** with a high gloss, gel coat finish.
2. External 3mm **plywood board** to increase structural strength.
3. 42mm **interlocking aluminium frame** – not timber – for extra strength and longevity.
4. Internal 3mm **plywood board**, CE coated for maximum durability.

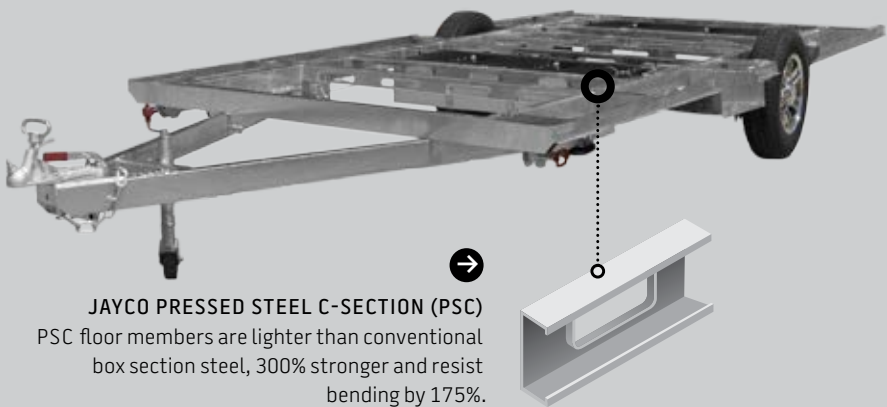

JAYCO ENDURANCE CHASSIS
An RV is only as strong as the base on which it's built, so we build our Endurance Chassis to last like no other. Lightweight yet super strong, it's hot dip galvanised for lifelong protection against corrosion, and features PSC member floor support, which better resist bending and compression, while also safeguarding under floor wiring and plumbing.

JAYCO OUTBACK

Some of Australia's must-see destinations – the places you really want to explore – lie well beyond the bitumen. To help you see them, with all the comforts of home, each Jayco Camper Trailer is also available in an Outback version, complete with a higher ground clearance, and a range of high-strength componentry and specialised features, including:

- JTECH Independent Suspension
- 100AH battery
- Rectangular hollow section galvanised bumper bar
- 150mm x 50mm rectangular hollow section chassis members
- 125mm x 50mm rectangular hollow section A-frame
- Jerry can holder on 'A-frame' (jerry can not included)
- AL-KO off-road electric brake magnets
- AL-KO outback drop jacks
- Protective aluminium checker plate on sides
- 15-inch alloy wheels with 235/75R15 tyres
- Vinyl spare wheel cover
- Pull-out double step
- External 12V auxiliary plug
- External gas bayonet
- Jayco mud flaps
- Solar provision.

Opting for a Jayco Outback version is not a licence to bush bash, mind you. But its extra strength and enhanced specifications will free you to travel the country's unsealed roads safely and arrive relaxed. Even so, always take extra care and reduce your speed, especially when driving in unfamiliar territory. If in doubt, do what the 4WD experts do – use your Jayco as a base station and head into rougher terrain without anything in tow.



JTECH SUSPENSION

Purpose designed to complement the Jayco Endurance Chassis, JTECH Suspension replaces beam axles with individual stub axles, allowing each wheel to react independently to the road surface, while also lessening the chassis' unsprung weight. Delivering **greater stability**, a **smoother ride**, more **precise handling** and **increased ground clearance without increased ride height**, it makes towing easier and safer than ever before.

Precision manufactured using automotive processes to ensure exact fitment, JTECH Suspension is the product of two years' research and development at Jayco's Melbourne headquarters, and countless kilometres of real world testing across the best and worst of Australian second class roads. Its features include:

- **ELECTROCOATED** surfaces for optimum protection against corrosion and stone chips
- **AL-KO STUB AXLES**, bearings and brakes that are suitable for fitment of AL-KO Electronic Stability Control
- Large diameter, heavy-duty **PEDDERS OFF-ROAD SHOCK ABSORBERS AND COIL SPRINGS** designed specifically for Jayco RVs and Australian conditions
- **AEON RUBBER SPRINGS** inside each coil spring, producing a progressing rate when the suspension is compressed; and
- **TOE-IN AND TOE-OUT** adjustment for wheel alignment



AL-KO ELECTRONIC STABILITY CONTROL
A. Critical swerve or sway is detected.
B. Electronic Stability Control partially applies the RV brakes. The caravan is pulled into line behind the tow vehicle. The sway is stopped and the caravan brakes are released.

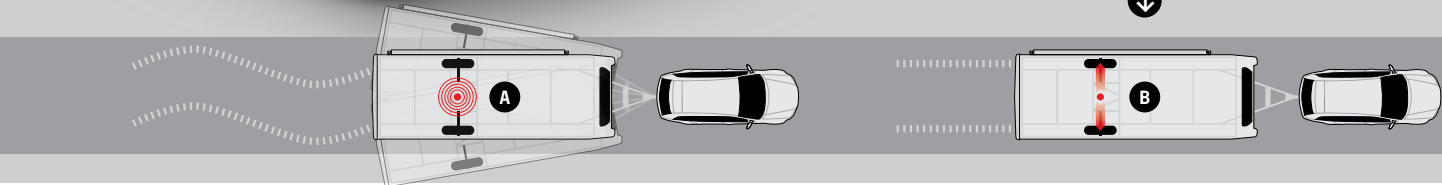

SPECIFICATIONS & FLOOR PLANS

PENGUIN	BODY LENGTH 4340 WIDTH 2240	TRAVEL LENGTH 5365	TRAVEL HEIGHT 1660 [OB +250]	INTERIOR HEIGHT 2070
---------	-----------------------------	--------------------	------------------------------	----------------------

TOURING / OUTBACK [OB]

tare weight (kg) 1000 / 1170
tow ball (kg) 112 / 125
bed width (mm) 1310
open length (mm) 5365

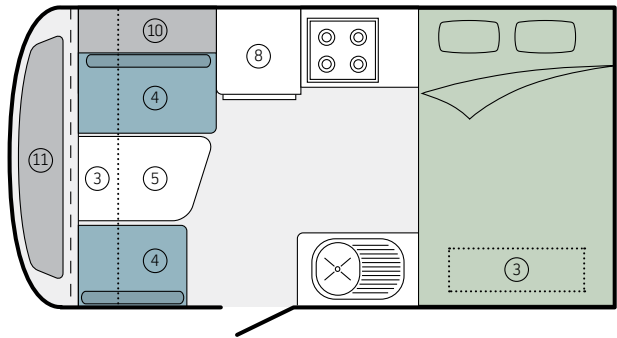

SWIFT	BODY LENGTH 2790 WIDTH 2240	TRAVEL LENGTH 4140	TRAVEL HEIGHT 1660 [OB +250]	INTERIOR HEIGHT 2070
-------	-----------------------------	--------------------	------------------------------	----------------------

TOURING / OUTBACK [OB]

tare weight (kg) 812 / 1020
tow ball (kg) 62 / 63
front bed width (mm) 940
rear bed width (mm) 1310
open length (mm) 4980

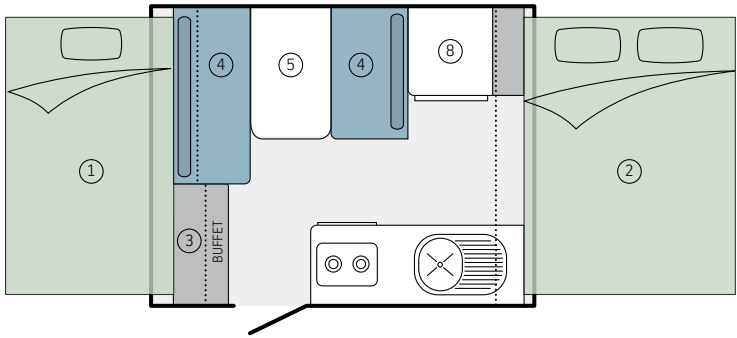

DOVE	BODY LENGTH 3750 WIDTH 2240	TRAVEL LENGTH 4770	TRAVEL HEIGHT 1660 [OB +250]	INTERIOR HEIGHT 2070
------	-----------------------------	--------------------	------------------------------	----------------------

TOURING / OUTBACK [OB]

tare weight (kg) 948 / 1174
tow ball (kg) 121 / 131
front bed width (mm) 1460
rear bed width (mm) 1140
open length (mm) 5810

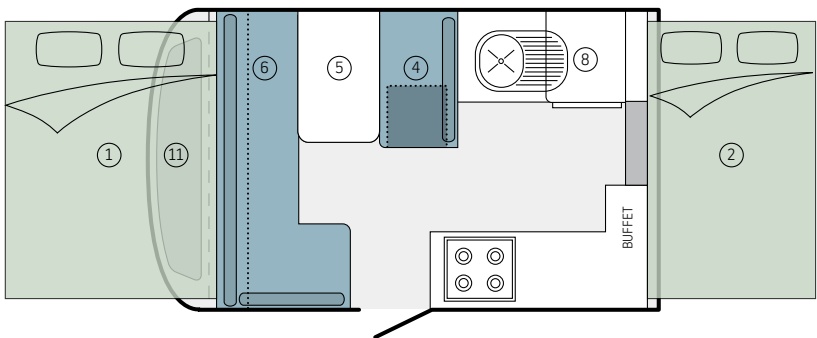

HAWK	BODY LENGTH 4040 WIDTH 2240	TRAVEL LENGTH 5060	TRAVEL HEIGHT 1660 [OB +250]	INTERIOR HEIGHT 2070
------	-----------------------------	--------------------	------------------------------	----------------------

TOURING / OUTBACK [OB]

tare weight (kg) 983 / 1207
tow ball (kg) 121 / 131
front bed width (mm) 1460
rear bed width (mm) 1140
open length (mm) 6200

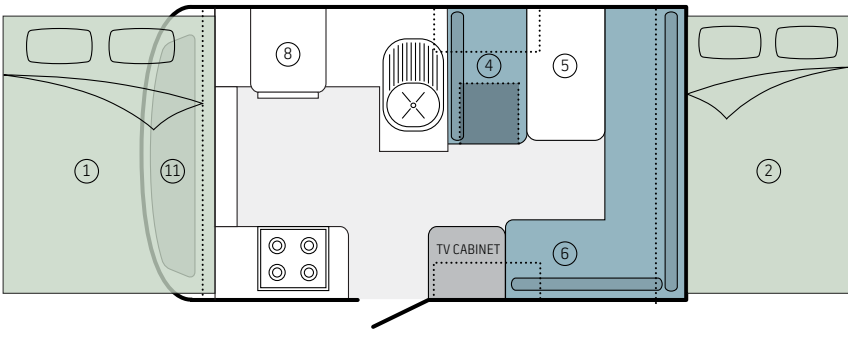

EAGLE	BODY LENGTH 4040 WIDTH 2240	TRAVEL LENGTH 5060	TRAVEL HEIGHT 1660 [OB +250]	INTERIOR HEIGHT 2070
-------	-----------------------------	--------------------	------------------------------	----------------------

TOURING / OUTBACK [OB]

tare weight (kg) 973 / 1189
tow ball (kg) 100 / 109
front bed width (mm) 1460
rear bed width (mm) 1140
open length (mm) 6200

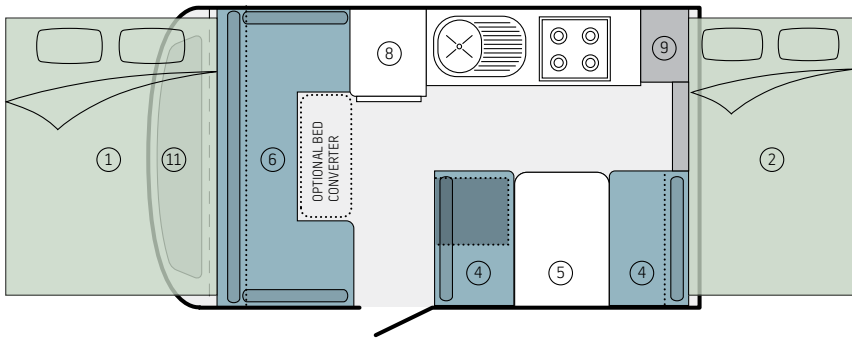

SWAN	BODY LENGTH 4340 WIDTH 2240	TRAVEL LENGTH 5365	TRAVEL HEIGHT 1660 [OB +250]	INTERIOR HEIGHT 2070
------	-----------------------------	--------------------	------------------------------	----------------------

TOURING / OUTBACK [OB]

tare weight (kg) 1067 / 1275
tow ball (kg) 96 / 109
front bed width (mm) 1460
rear bed width (mm) 1310
open length (mm) 6505

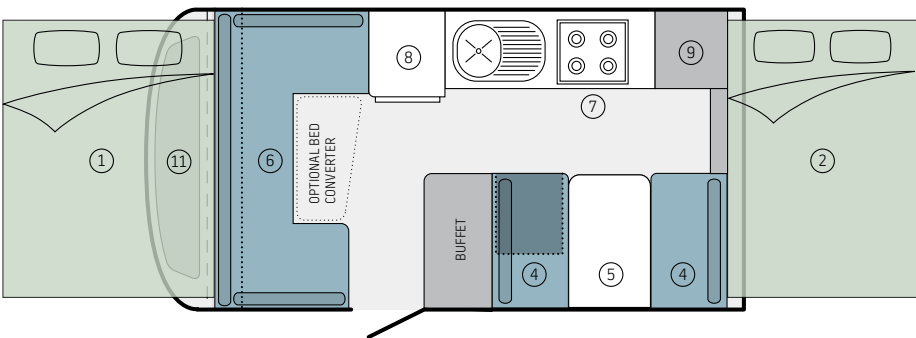

FLAMINGO	BODY LENGTH 4340 WIDTH 2240	TRAVEL LENGTH 5365	TRAVEL HEIGHT 1660 [OB +250]	INTERIOR HEIGHT 2070
----------	-----------------------------	--------------------	------------------------------	----------------------

TOURING / OUTBACK [OB]

tare weight (kg) 1042 / 1270
tow ball (kg) 82 / 99
front bed width (mm) 1460
rear bed width (mm) 1310
open length (mm) 6505

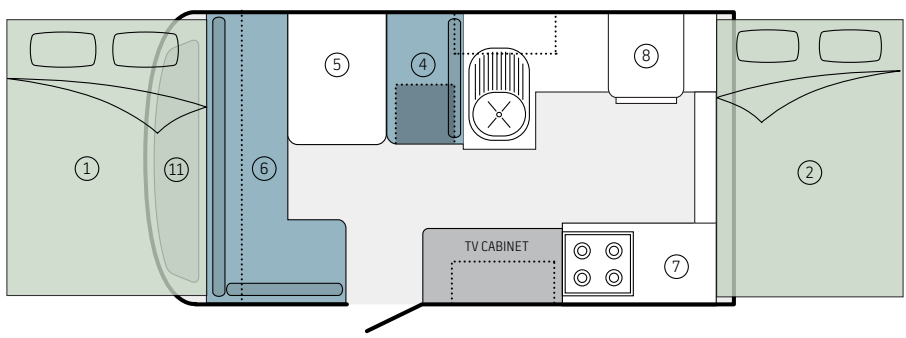

Jayco allow an amount of additional weight (Carrying Load) for each individual unit manufactured above the initial manufactured Tare Weight of the unit. This 'Carrying Load' is for the customers individual weight requirements and can be made up of 'any' additional weight they propose to load the unit up of. ie water, food, clothes etc.

The standard unit carrying load Jayco applies is:
Single Axle; 300kg

Outback travel heights increase by 250mm
Outback travel lengths increase by 250mm

The tare and tow ball weight is only a guide and will change depending on accessories which are fitted to your van. It is advisable to discuss with your Jayco Representative.

KEY

- 1 Front bed
- 2 Back bed
- 3 Overhead storage
- 4 Seat
- 5 Table
- 6 Club Lounge
- 7 Microwave
- 8 Fridge
- 9 Robe
- 10 Storage
- 11 Front boot

FEATURES

	Touring	Outback
INTERIOR		
Battery - Setec 12V/240V Management System	●	●
Battery - 100amp Deep Cycle	○	●
Bed Converter Club Lounge*	○	○
Bed Converter Dinette	●	●
Bed - Front Large Parents bed (1430mm wide)*	●	●
Control panel - Coast to Coast	○	○
Control panel - Drifter	○	○
Curtains - Rubber backed removable & washable	●	●
Drawers - Ezi glide pullout	●	●
Floor Vinyl - Durable modern design	●	●
Hatch Roof 360mm x 360mm	●	●
Lights - Reading 12V & fan to bed ends (N/A on Penguin)	●	●
Lights - Ceiling 12V LED 2 Tone	●	●
Locks - Positive to cupboard doors	●	●
Power point with USB charger	●	●
Power - 240V	●	●
Privacy Dividers	●	●
Sink - Stainless Steel Large bowl with Chop 'n' Serve board	●	●
Storage under seats	●	●
Tap - Hand pump to Sink	●	●
Tap Mains pressure to sink	●	●
TV outlet	●	●
Appliances		
Air Conditioning - Roof Mounted (Truma)	○	○
Cooktop - 4B0 with 1 x 240V element (N/A on Swift & Dove)	○	○
Cooktop - Smev 4BG with 1 x 240V hotplate (N/A on Swift)	●	●
Cooktop - Spinfo 2 Burner (Swift only)	●	●
Fridge - Thetford N304 93 Lt 3 way	●	●
Hot Water Service - 22 Lt Dual Gas/240V Operation (N/A on Swift & Dove)	○	○
Microwave (Swan & Flamingo)	●	●
Stereo - Fusion CD/Radio System with external Speakers	○	○
Stereo - Fusion Premium CD/DVD/Radio System, External Speakers & App Functionality	○	○
TV Aerial - 12V power boosted (N/A with Roof Racks)	○	○
TV/DVD - Sphere LED 12V (18.5")	○	○
Comfort		
Dinette Seating with durable designer fabric	●	●
Mattress - Innerspring	●	●
Seat Foam - Dunlop high resilience & Antibacterial	●	●

Safety		
Bed child restraints - Rear bed/top bunk	●	●
Brake magnets - off-road	-	●
Brakes - Electric	●	●
Cooktop Flame Failure device (N/A on Swift)	●	●
ESC - AL-KO Electronic Stability Control device	○	○
eZylevel levelling device	○	○
Fire Extinguisher	●	●
Lights - Side LED Running	●	●
Roof Switch - 12V power auto cutoff	●	●
Water Filler - Lockable	●	●

● Standard ○ Optional *Selected layouts

	Touring	Outback
EXTERIOR		
Awning - Bag	○	○
Awning - Fiamma (N/A Swift)	○	○
Awning Walls	○	○
Bag Flies	○	○
BBQ - Slideout (N/A on Swift)	○	○
Bed System - Pullout	●	●
Bike Racks to Roof Racks	○	○
Boot - Front with Large storage & gas strut assisted (N/A on Swift)	●	●
Bumper Bar (Swan & Flamingo)	●	-
Bumper Bar - RHS Galvanised	-	●
Checkerplate - Protective black side bottom panels	-	●
Coupling - Shockproof swivel	-	○
Door - External trunk (N/A on Swift)	●	●
Door Main Entrance - External 2 piece folding	●	●
Front & Rear ABS Smooth - Modern styling (N/A on Swift)	●	●
Gas Bayonet	○	●
Gas Bottles - Fixed	1	1
Jack - For Spare Wheel	●	●
Jacks - Cnr Supports AL-KO drop	○	●
Jacks - Cnr Supports windowdown	●	-
Jerry Can Holder	○	●
Light - LED Annexe	●	●
Mudflaps - Jayco	○	●
Outback Package	○	●
Pebbleguard Stone protection at front	●	●
Plug Car 12 Pin	●	●
Power - 12V Weather Proof Cig Socket	○	●
Power - 240V Weather Proof Outlet	●	●
Roof Racks	○	○
Shower - External (N/A on Swift & Dove)	○	○
Solar System - 120 watt & Regulator	○	○
Solar wiring prov	●	●
Step Double pull out	-	●
Step Single pull out	●	-
Suspension - Axle & Leaf springs	●	-
Suspension - JTECH Suspension Independent Coil	○	●
Tap - Mains pressure to Aframe	○	○
Tent design - coloured	-	●
Tent Section - Heavy Duty with Bradmill Canvas & Boltiflex	●	●
Ventilation - Tent windows flyscreens	●	●
Water Tank - 82 Lt under floor (75 Lt on Swift OB)	●	●
Water Tank - Additional 82 Lt (N/A Swift)	○	○
Water Tank Guard	●	●
Wheel - Alloy Spare	●	●
Wheel - Cover for Spare	●	●
Wheels - 16" 245/70R16	-	○
Wheels - Alloy with radial tyres (inches)	14	15
Wheels - Nitrogen filled	●	●
Construction		
Chassis - Endurance Hot Dipped Galvanised	●	●
Chassis - Main Members 4" x 2"	●	-
Chassis - Main Members 6" x 2"	-	●
Furniture - Euro Style with aluminium cnr styles	●	●
Furniture - Euro Style with aluminium seat framing	●	●
Roof - Hail resistant one piece skin with Sandwich insulation	●	●
Walls - Maxi Frame Ali stud construction	●	●
Walls - Skin Smooth Hail & Dent Resistant	●	●

JAYCO OPTIONS

ADD THAT PERSONAL TOUCH It's through individual touches that the Jayco you choose becomes your own truly personal, home away from home. That's why we complement our range of feature packed floor plans with a selection of high quality optional extras – all of them designed to integrate seamlessly with your Jayco, operate effortlessly, and look fabulous. Here are just a few:



- 01 Versatile roof racks let you carry a range of additional cargo.
- 02 Check water and battery levels at a glance with the Coast to Coast control panel.
- 03 Bag flies keep bed ends shaded and more private.
- 04 CD/Radio stereo system includes both indoor and outdoor speakers.
- 05 Roof-mounted air conditioning to keep you cool throughout summer.
- 06 An external shower helps keep dirt and sand outside, where it belongs.

- 07 Add an outdoor room the easy way with a bag awning and walls.
- 08 Catch your favourite shows on the 18.5" 12 volt LED TV with DVD player.
- 09 Have power to spare with the 120 watt solar system and regulator.
- 10 With a slide out BBQ you can entertain while you cook (select models only).
- 11 A high quality Fiamma awning makes every spot, a shady spot.



TRIMS

FREEDOM OF CHOICE The freedom you'll enjoy with your Jayco begins before you even place your order. We offer a wide range of great looking, hard-wearing, easy-to-clean finishes, fabrics and soft furnishings in both contemporary and classic styles, for you to choose and coordinate as you wish.



BOLSTER CUSHION

BASE CUSHION

PROUDLY SUPPORTING THE PURSUIT OF GOOD HEALTH Across four decades, Jayco has passionately supported community health initiatives, charities, sports and sporting teams. Our commitment to contribute to those in need, promote the benefits of an active lifestyle, and assist sports people achieve their potential – be it at elite level or grass roots – remains undiminished. Below are just a few ways we're helping make a difference today. For more, visit jayco.com.au.



WOMEN'S NATIONAL BASKETBALL Long time supporters of women's basketball, Jayco is now naming rights sponsor for the Opals, the Emerging Opals, the Under-19 Gems and Under-17 girls' national teams.

STATE OF THE ART COMPLEX

Built in Australia since 1975 - and still going strong. In 2007, Jayco moved into its current 50-acre state of the art complex at 1 Jayco Drive, Dandenong South, Victoria, with a purpose-built 60,000sqm undercover manufacturing complex. This is where all Jayco RVs are made.

Australia's most recognised brand for quality and affordable recreational vehicles, Jayco is a great success story of Australian manufacturing.

Employing over 1,000 Australians, Jayco continues as a locally owned family business.



TO BE THE BEST, you need to work with the best



JAYCO.COM.AU 1300 JAYCO RV

CONNECT



Visit your Jayco Dealer: